

Pg. 238

Henry Mussleman's other Land

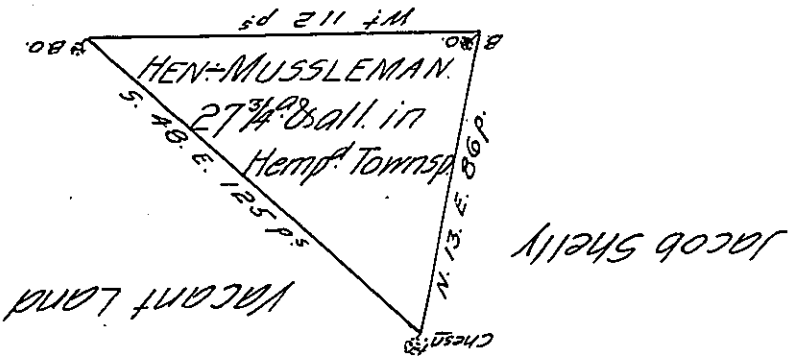

A Draught of Henry Mussleman's Land situate in Hempf^d Township, in the County of Lancaster, containing twenty seven Acres $\frac{3}{4}$ & the usual allowance, by Virtue of the Honble Proprietaries Warrant bearing date the Eleventh day of April in the year of our Lord 1745. Surveyed the thirteenth day of January in the year of our Lord 1745.

pr. Tho = Cookson

To Mr W^m Parsons.

D: 5^c

Surveyor General

IN TESTIMONY that the above is a copy of the original remaining on file in the Department of Internal Affairs of Pennsylvania, made conformably to an Act of Assembly approved the 16th day of February, 1833, I have hereunto set my Hand and caused the Seal of said Department to be affixed at Harrisburg, this third day of November 1905.

Jacob D. Pearson
Secretary of Internal Affairs.